

Hereford Road

ST WERBURGHS

APPROXIMATE FLOOR AREA
93.8 SQM / 1010 SQFT



Ground Floor

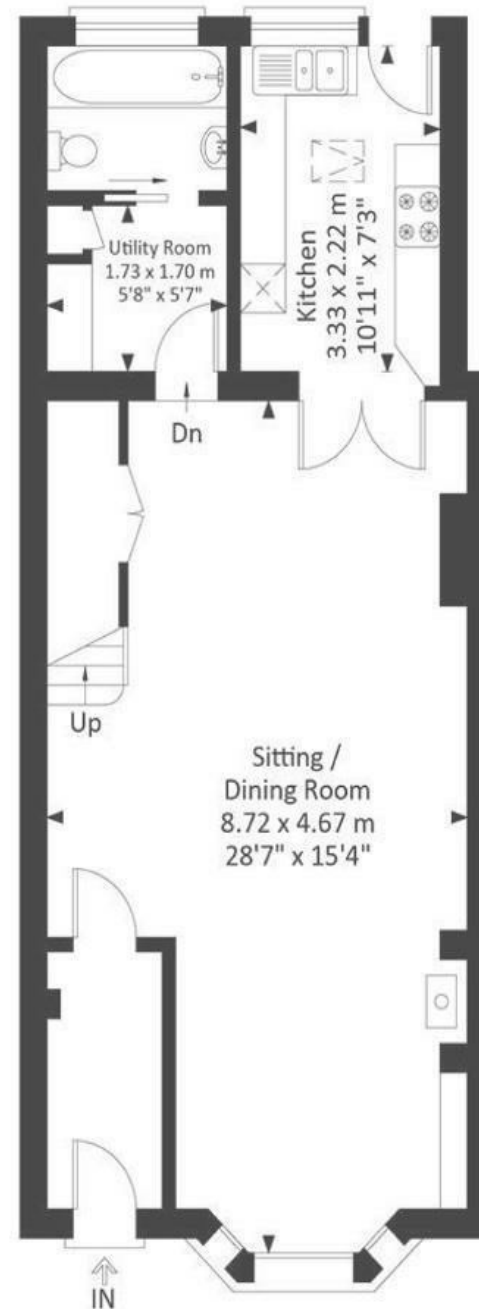

First Floor



Illustrations are for reference purposes only, measurements are approximate, not to scale.

Boardwalk

Hereford Road

ST WERBURGHS, BRISTOL

£

£425,000



BS2 9UW

zzz

2 Bedrooms



2 Bathrooms

"We've loved calling 20 Hereford Road our home for the last six years and will cherish the memories made here. The quiet cul-de-sac location on a friendly street is perfect. The openness of the downstairs makes for unforgettable gatherings with family and friends. We love smelling the jasmine through the open front window in the summer and snuggling up by the log burner on cold winter evenings. Our home is in St Werburghs - full of wonderful people, restaurants, pubs and beautiful green spaces."

